

# TECHNICAL SPECIFICATIONS

# T200 H

# TECNA

Breaker code

Rev.

Year

T02000

2.0

2016

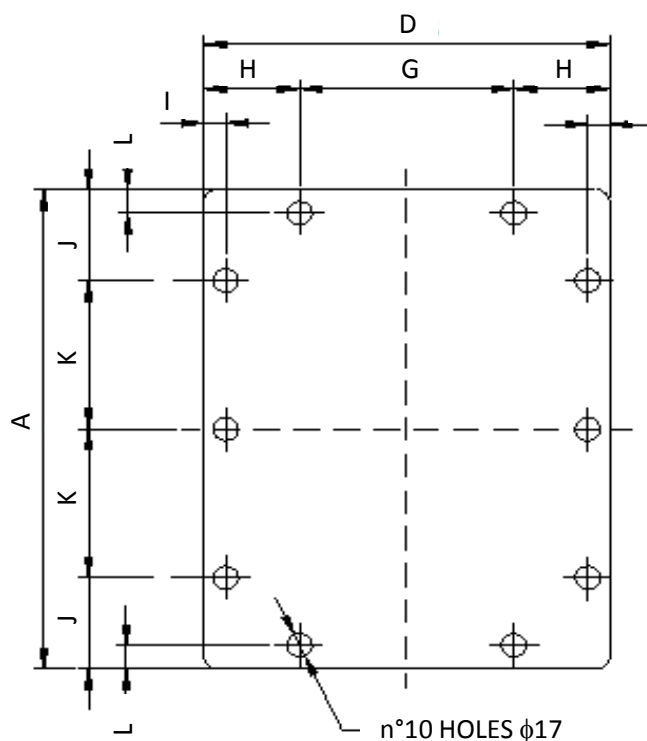
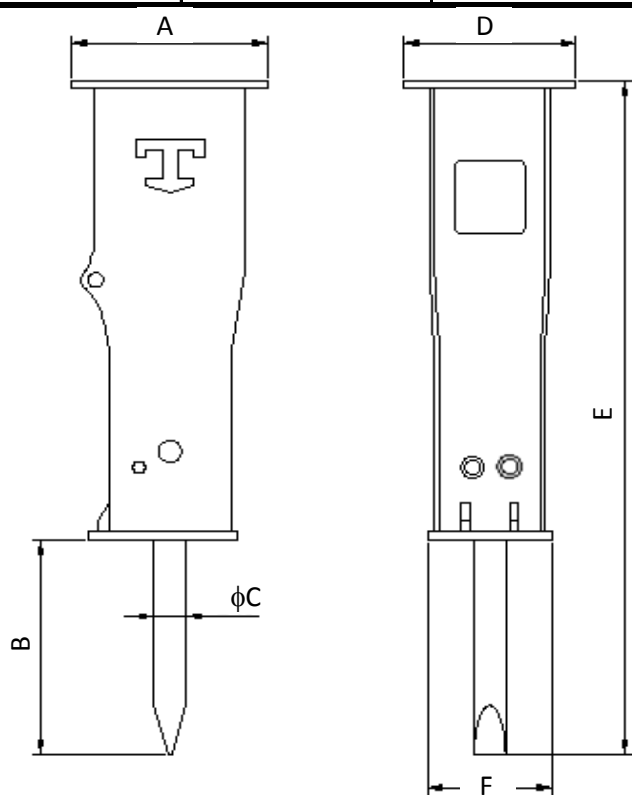

	mm	in		mm	in
A	355	14,0	G	145	5,7
B	276	10,9	H	65	2,6
φ C	56	2,2	I	15	0,6
D	275	10,8	J	67,5	2,7
E	1098	43,2	K	110	4,3
F	188	7,4	L	17,5	0,7

I	GB	E	D	METRIC UNIT / IMPERIAL UNIT		
---	----	---	---	-----------------------------	--	--

PESO ESCAVATORE	SUITABLE EXCAVATOR	PESO EXCAVADORA	GEEIGNET FÜR TRÄGERGERÄT	2,5 ÷ 4,5	Ton	5512 ÷ 9921	lbs
PESO MEDIO OPERATIVO	OPERATING WEIGHT	PESO MEDIO OPERATIVO	ARBEITSGEWICHT DES HAMMERS	200	Kg	440,9	lbs
DIAMETRO UTENSILE	TOOL DIAMETER	DIAMETRO PICA	MEISSEL DURCHMESSER	56	mm	2,20	in
PORTATA	OIL SUPPLY	CAUDAL	ÖLBEDARF	35 ÷ 55	l/min	9 ÷ 15	GPM
PRESSIONE DI LAVORO	BREAKER WORKING PRESSURE	PRESSION EN EL MARTILLO	ARBEITSSOLDRUCK IM HYDRAULIKHAMMER	100 ÷ 140	bar	1450 ÷ 2031	PSI
PRESSIONE REGOLATA ALL'ESCAVATORE	RELIEF PRESSURE SETTING	PRESSION EN LA EXCAVADORA	ARBEITSSOLDRUCK IM TRÄGERGERÄT	180	bar	2611	PSI
CONTROPRESSIONE MAX	MAX BACK PRESSURE	CONTRAPRESSION MAX	MAX STAUDRUCK	20	bar	290	PSI
POTENZA INGRESSO (MAX)	INPUT POWER (MAX)	POTENCIA DE ENTRADA (MAX)	EINGANGS LEISTUNG (MAX)	11	Kw	14,7	HP
CLASSE DI ENERGIA D'URTO	IMPACT ENERGY CLASS	ENERGIA DE IMPACTO CLASE	KLASSE SCHLAGENERGIE	594	J	438	Ft/lbs
NUMERO DI COLPI AL MINUTO	IMPACT RATE	GOLPES MINUTO	SCHLAGZAHL PRO MINUTE	700 ÷ 1000	BPM	700 ÷ 1000	BPM
TEMPERATURA MAX OLIO IDRAULICO	MAX TEMPERATURE HYDRAULIC OIL	TEMP. MAX DE ACEITE HIDRAULICO	MAX ÖLTEMPERATUR	80	°C	176	°F
TUBAZIONE IMPIANTO MANDATA (Ø min.)	RECOMMENDED INLET LINE SIZE (Ø min.)	TUBERIA INSTALACION PRESION (Ø min.)	EMPFOHLENE VORLAUF LEITUNG (Ø min.)	12	mm	0,47	in
TUBAZIONE IMPIANTO RITORNO (Ø min.)	RECOMMENDED RETURN LINE SIZE (Ø min.)	TUBERIA INSTALACION RITORNO (Ø min.)	EMPFOHLENE RUECKL. LEITUNG (Ø min.)	14	mm	0,55	in
LUNGHEZZA CONSIGLIATA TUBI FLESSIBILI	SUGGESTED MIN FLEX HOSES LENGTH	LONGITUD MAXIMA LATIGUILLO	LÄNGE HAMMER ANSCHLUSS SCHLAUCH	1600	mm	63,0	in
ATTACCO INGRESSO DEMOLITORE	HOSE CONNECTION AT THE BREAKER'S RETURN LINE	RACOR PRESSION MARTILLO	HAMMER SCHLAUCH RÜCKLAUF	1/2" G		1/2" G	
ATTACCO USCITA DEMOLITORE	HOSE CONNECTION AT THE BREAKER'S INLET LINE	RACOR RITORNO MARTILLO	HAMMER SCHLAUCH VORLAUF	1/2" G		1/2" G	